

- Proposed tree Planting
- Proposed Planting & Hedging

Trees to be Removed



Rev A :30.11.06
Layout of building revised.
Electric Sub-Station relocated to southern boundary.

Rev B 09.07.07
Layout of access to Greystones House amended.

ALL DIMENSIONS TO BE CHECKED ON SITE
HOW TO MEASURE DIMENSIONS ONLY
NEVER DIMENSIONS TO THE INTERIOR
- ALL DIMENSIONS PROVIDED
COPYRIGHT ACT APPLIES

THE PLANNING BUREAU LIMITED

Town Planners and Architects
Design Director
G. H. Martin, B.A., Hon. Arch., R.A., R.I.B.A.
Newcastle Business Park, 1000 Parkway
Newcastle upon Tyne, NE12 5SQ
Telephone: 0191 435 822



Client:
Project Title
Cat. II Sheltered Flats
Barton Cottage
Malton

Drawing Title
Site Layout Plan

Scale: 1/250 Date: ADF 2007
Drawn: DSB Checked: [blank]
Drawing No.: 1483/02/03B

Drawn Ref: [blank]
CALL plot date

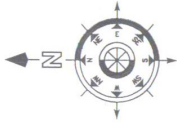

LIGHTING KEY:

1. All existing and new lighting of site
 2. All existing and new lighting of site
 3. All existing and new lighting of site
 4. All existing and new lighting of site

1. All existing and new lighting of site
 2. All existing and new lighting of site
 3. All existing and new lighting of site
 4. All existing and new lighting of site

Areas of new parking

 THE PLANNING BUREAU LIMITED 100, The Quadrant, London, W1R 0AS Tel: 0181 444 4222 Fax: 0181 444 4210	Client Mr. & Mrs. J. & K. Stone 100, The Quadrant, London, W1R 0AS	Design Director G. L. Day B.Sc., B.Arch., R.I.B.A. Tel: 0181 444 4222 Fax: 0181 444 4210	Project No. 1483/02/12
Date: 11/02/12 Drawn: JLD Checked: JLD Scale: 1:100	Drawing Title Site Plan Extra Parking Bays over planning	Project No. 1483/02/12	Date: 11/02/12 Drawn: JLD Checked: JLD Scale: 1:100

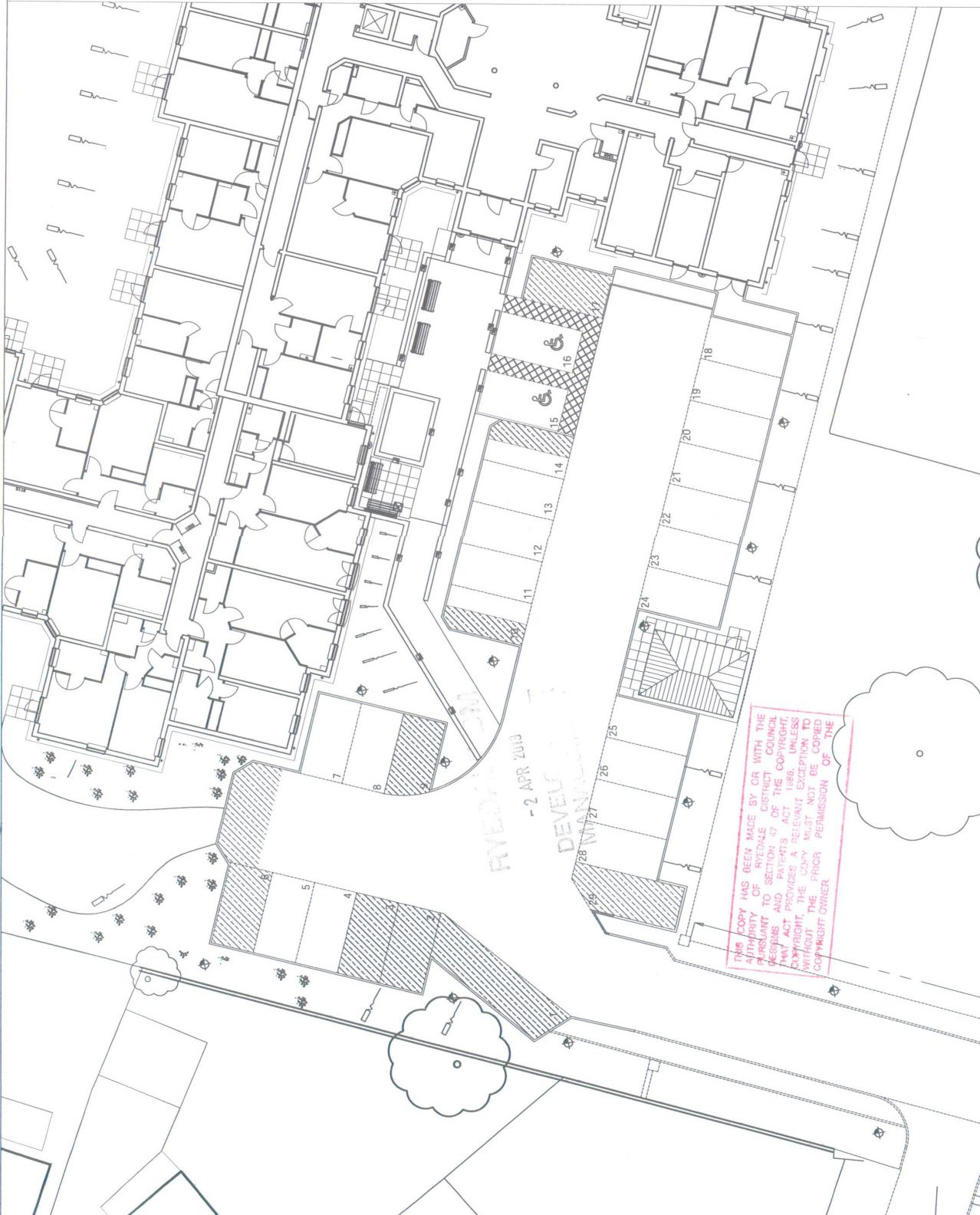

THIS COPY HAS BEEN MADE BY OR WITH THE
 AUTHORITY OF RYEDALE DISTRICT COUNCIL
 PURSUANT TO SECTION 47 OF THE COPYRIGHT,
 PATENTS AND DESIGNS ACT 1988, UNLESS
 THAT ACT PROVIDES OTHERWISE. A RELEVANT EXCEPTED
 COPYRIGHT, THE COPY MUST NOT BE COPIED
 WITHOUT THE PRIOR PERMISSION OF THE
 COPYRIGHT OWNER

- 2 APR 2013
 DEVELOPMENT